

PLAT OF WALKERS SUBDIVISION

OF THAT PORTION OF THE

MILL RESERVE IN THE VILLAGE OF STANDISH. ARENAC CO. MICH.

RECEIVED AND FILED
IN AUDITOR GENERAL'S OFFICE
September 8 1892
M.R.Hart
Deputy Auditor General

Lying east of Rail Road
described as follows.
commencing at south east corner of mill reserve, running thence
west 150 feet, thence north 60 feet, thence east 150 feet, thence south 60 feet
to place of beginning

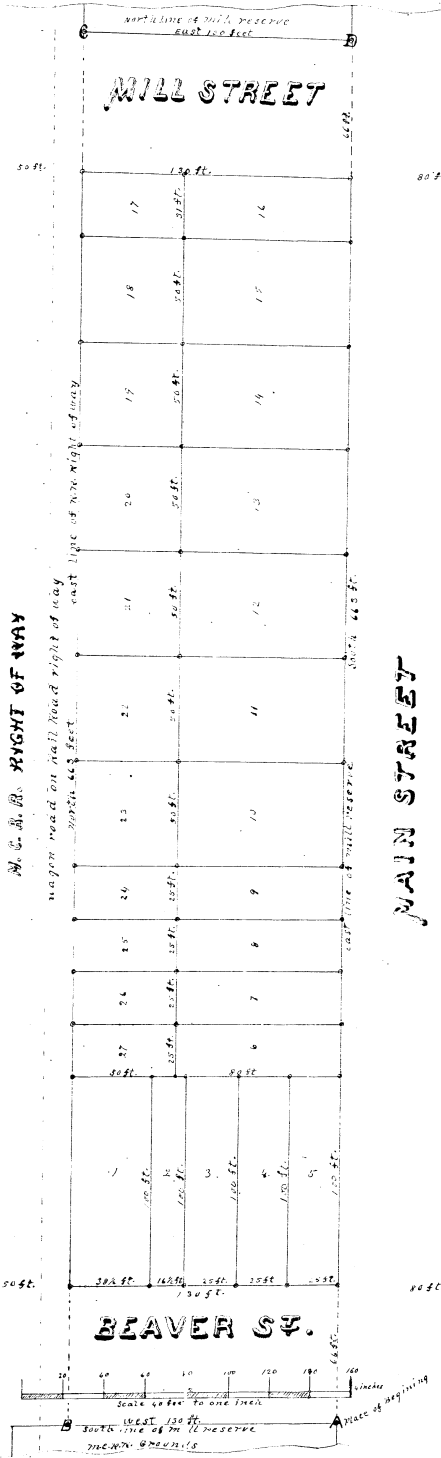

Dedication

I, Sarah J. Corbin, do hereby represent that I own the land embraced in the above plat, and do hereby dedicate the same to the public use of the village of Standish, Michigan, and that the streets and alleys shown on the plat are hereby dedicated to the use of the public.

In presence of
Sarah J. Corbin
State of Michigan
County of Arenac
Notary Public, Arenac, Mich.

Witness my hand and seal this 25th day of April, 1892.

Examined and Approved
Aug 17 1892
L. C. B. R.

State of Michigan
County of Arenac
Register of Deeds
I, Harvey A. Chamberlain, Register of Deeds, do hereby certify that we have each carefully compared this copy with the original plat of Walker's Subdivision of the Village of Standish, and that it is an exact copy thereof and of the whole of such original plat.

Witness my hand and seal this 15th day of August A.D. 1892.

State of Michigan
County of Arenac
Register of Deeds
I, Harvey A. Chamberlain, Register of Deeds, do hereby certify that we have each carefully compared this copy with the original plat of Walker's Subdivision of the Village of Standish, and that it is an exact copy thereof and of the whole of such original plat.

Witness my hand and seal this 15th day of August A.D. 1892.

Course and widths of Streets

The streets marked "Mill Street" and "Beaver St." on this plat are a continuation of the same streets marked "Mill Street" and "Beaver St." in the original plat of the village of Standish, and are each 150 feet wide, the former running parallel with the north boundary, and the latter parallel with the south boundary.

Size of Lots

Lot 1 is 150 feet wide and 100 feet long, lot 2 is 150 feet wide and 100 feet long, lots 3 and 4 are each 150 feet wide and 100 feet long, lots 5 and 6 are each 150 feet wide and 100 feet long, lot 7 is 150 feet wide and 100 feet long, lot 8 is 150 feet wide and 100 feet long, lot 9 is 150 feet wide and 100 feet long, lot 10 is 150 feet wide and 100 feet long, lot 11 is 150 feet wide and 100 feet long, lot 12 is 150 feet wide and 100 feet long, lot 13 is 150 feet wide and 100 feet long, lot 14 is 150 feet wide and 100 feet long, lot 15 is 150 feet wide and 100 feet long, lot 16 is 150 feet wide and 100 feet long, lot 17 is 150 feet wide and 100 feet long, lot 18 is 150 feet wide and 100 feet long, lot 19 is 150 feet wide and 100 feet long, lot 20 is 150 feet wide and 100 feet long, lot 21 is 150 feet wide and 100 feet long, lot 22 is 150 feet wide and 100 feet long, lot 23 is 150 feet wide and 100 feet long, lot 24 is 150 feet wide and 100 feet long, lot 25 is 150 feet wide and 100 feet long, lot 26 is 150 feet wide and 100 feet long, lot 27 is 150 feet wide and 100 feet long.

Monuments and witness trees

At south east corner of lot 1 is a witness tree 12-18 inches diameter marked on plat as "witness tree". At south west corner of lot 1 is a witness tree 12-18 inches diameter marked on plat as "witness tree". At north east corner of lot 1 is a witness tree 12-18 inches diameter marked on plat as "witness tree". At north west corner of lot 1 is a witness tree 12-18 inches diameter marked on plat as "witness tree". At south east corner of lot 2 is a witness tree 12-18 inches diameter marked on plat as "witness tree". At south west corner of lot 2 is a witness tree 12-18 inches diameter marked on plat as "witness tree". At north east corner of lot 2 is a witness tree 12-18 inches diameter marked on plat as "witness tree". At north west corner of lot 2 is a witness tree 12-18 inches diameter marked on plat as "witness tree".

Surveyors Certificate

We hereby certify that the plat herein presented is a correct and true copy of the original plat of the village of Standish, and that the same has been printed at the office of the Register of Deeds, and that the same is a true and correct copy of the original plat of the village of Standish, and that the same is a true and correct copy of the original plat of the village of Standish.

Recorded for Record the 10th day of August A.D. 1892 at 10 o'clock A.M. and returned in Liber 11 of Deeds at page 111
Harvey A. Chamberlain
Reg. of Deeds